





## LEGENDA

-  Lâmpada LED - Base E-27W - 35 UND
-  Interruptor Simples 17 UND
-  Tomada a 0,30 do piso - 29 UNDD
-  Caixa de distribuição
-  Cabo 10 mm - 200 m
-  PONTO DE LUZ

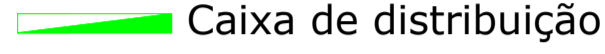
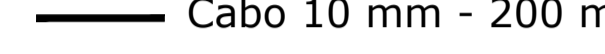

### REDE DE ESGOTO-EXECUTADO

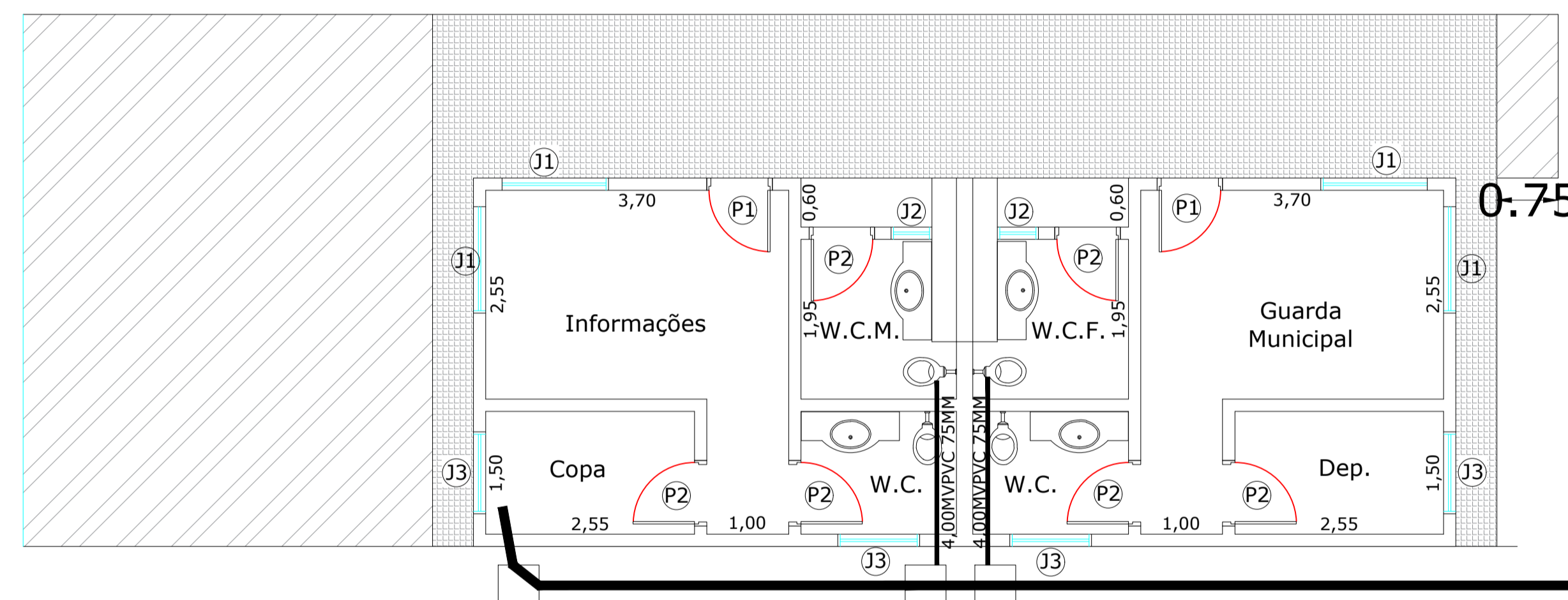
Escala 1:100

### PADRÃO DE ÁGUA

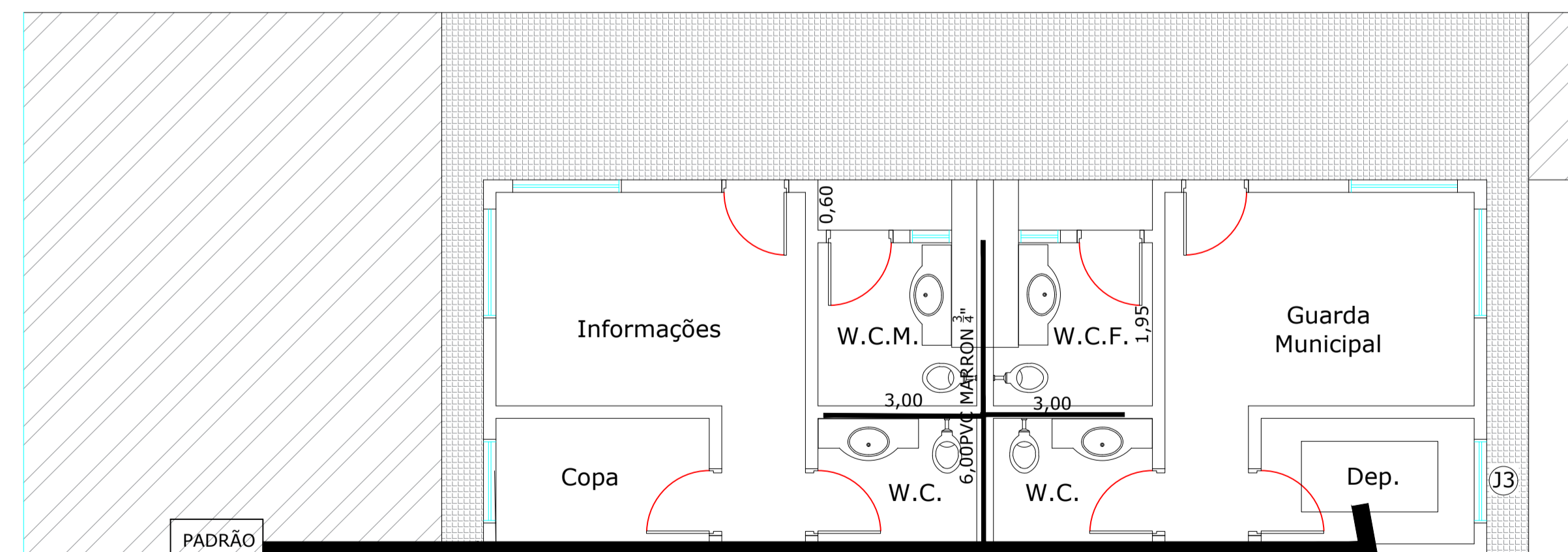

### REDE DE ÁGUA-EXECUTADO

Escala 1:100

## PREFEITURA DO MUNICÍPIO DE ANGATUBA

Obra:  
Projeto para término construção de um Portal na entrada da  
Cidade  
Localização:  
Acesso "Ivens Vieira", Km 2,5 - Angatuba - SP

LUIZ ANTONIO MACHADO  
Prefeito do Município de Angatuba

Folha:  
**04**

Eng.º Civil Henrique José Alciati  
CREASP - 060088102-3  
Responsável Técnico  
ART Nº 28027230191184908

Escala:  
1:100

Revisão:  
1

Data:  
SET.2019